

82/44 - 52 Kent Street, Epping 2121, NSW Deposit Taken!!

Apartment Rent ID: 4016065

\$2,240 bond



Deposit Taken!! MODERN 2 BEDROOM APARTMENT FOR LEASE

Deposit Taken!!

Located in the heart of Epping, the brand new apartment can meet everything you want. Shortly walk to shops, train station and surrounding parks. Short drive to Macquarie Centre, Eastwood and Ryde. Minutes from Ryde and Macquarie Hospitals and close to Lane Cove National Park

Date Available
now

Inspections
Inspections are by
appointment only

Features:

Spacious open living and dining areas

Contemporary kitchen include beautiful benches, quality appliances

Carpeted bedrooms with build-in wardrobes and ensuites

Air conditioning

Security video intercom

Why pay for your bond now,
when you can pay it off later?
Visit: www.rent.com.au/rentbond

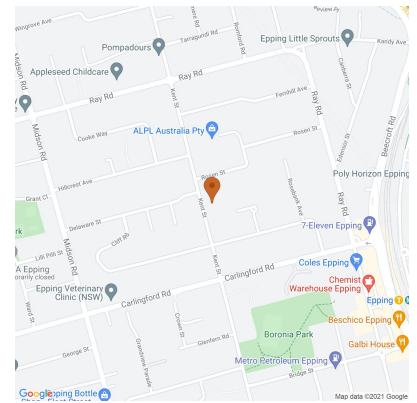

Leasing Enquiry
Mobile: 0291922831
Phone: 0291922831
rent@pia.com.au

82/44 - 52 Kent Street, Epping 2121, NSW

Deposit Taken!!

Apartment Rent ID: 4016065

\$2,240 bond



Why pay for your bond now,
when you can pay it off later?
Visit: www.rent.com.au/rentbond

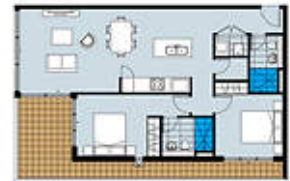

Property details continued from page 1:

...

Secure parking space

Airconditioning

Air Conditioning

Garage

Secure Parking

Kitchen

Dishwasher

Security

Alarm System

Intercom